



7100 147th Street West
Apple Valley, MN 55124-9016

Telephone (952) 953-2588
www.cityofapplevalley.org

RESIDENTIAL FENCES

Fence Permits: Building permits are required for fences over seven feet in height. Fences under seven feet in height do not require a building permit but must meet the location and City ordinance requirements.

Fence Locations: All fences must be located entirely upon the private property owned by the person erecting the fence; including the concrete footing. The fence may be placed directly on the property line **if the adjoining property owner agrees in writing**. Generally, fences may be erected up to a height of eight feet in the rear and side yard areas. Maximum height in the front yard area is 3 ½ feet.

Pool fences: If the pool fence is constructed at the same time of pool installation, and a fence is required, then a separate fence permit is not required. If replacing a required pool fence, a fence permit will be required.

Maintenance: All fences must be constructed in a workman-like manner and be maintained in a reasonable state of repair so as not to become a hazard or nuisance.

ITEMS REQUIRED WITH THE PERMIT APPLICATION

Site plan: A survey showing the lot lines, location of the house and the proposed location of the fence must be submitted with the fence location drawn on it.

Drawings: A drawing or picture of the fence must be provided. Supply the location of the support posts.

Design: Fences over seven feet in height shall be designed by a licensed Structural Engineer or by a fence contractor. The design must meet the requirements of the State Building Code.

Agreements: If the fence will be located on the property line, **a written agreement with the owner of the adjoining property must be provided to the City.**

INSPECTIONS REQUIRED

- Footing Inspection:** A footing inspection is required for all fences that are over seven feet in height. **The owner or a surveyor must locate the property line and the corner stakes shall be marked.**
- Final Inspection:** A final inspection should be scheduled after the fence is complete.

ILLUSTRATION OF ALLOWABLE FENCE LOCATIONS AND HEIGHTS

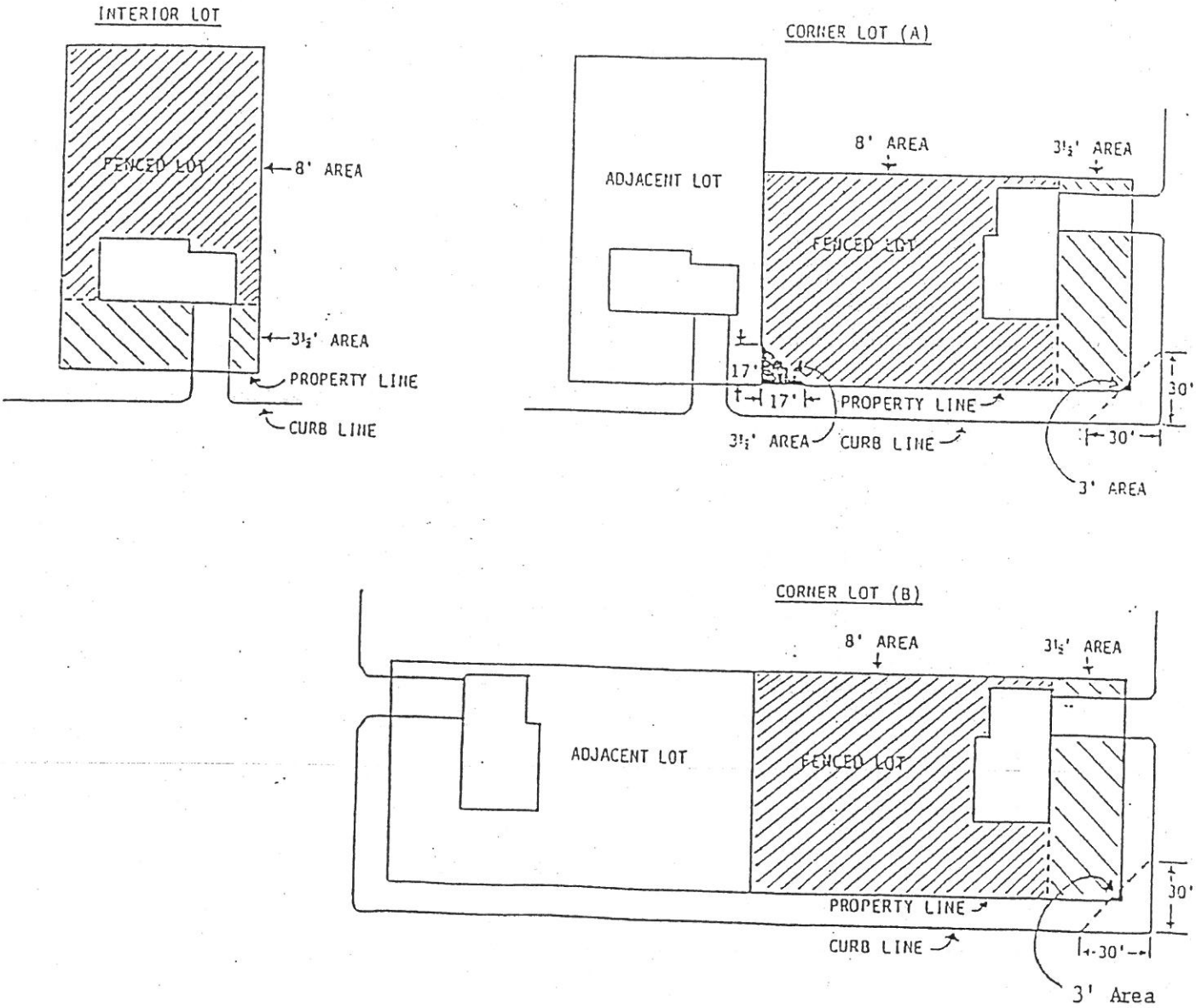

This handout is written as a guide to the most common questions and problems and is not intended nor shall it be considered a complete set of requirements.



City of Apple Valley Residential Building Permit Application

7100 147th Street W, Apple Valley MN 55124

952-953-2588

ALL INFORMATION IS REQUIRED

Site address _____

Property Owner _____ Phone _____

Address (if different from site address) _____

Contractor _____ Phone _____

Email Address _____

Address _____ City _____

State _____ Zip _____ Contact Name _____ Phone _____

State of MN contractor license # _____ License Verification _____

(Office Use Only)

WORK DESCRIPTION: (Specify Square Footage and Specific Work to be Completed)

\$ _____ **Valuation of Work (Labor and Materials)**

A building permit is issued on the condition that all work shall be done in accordance with the Apple Valley City Code. Required inspections must be scheduled and approved for each project.

Applicant is: _____ Property Owner _____ Contractor _____ Other _____

Signature of Applicant _____

Date _____

FOR CITY OF APPLE VALLEY USE ONLY!

Building permit \$ _____ Surcharge \$ _____ Total \$ _____

Date paid _____ Check# _____ Permit # _____

Reviewed By: _____ Separate Permits Required _____ Electrical _____ Plumbing _____ Mechanical _____ Fire Sprinkler _____

Inspections Required

- | | | |
|--------------------|----------------------------|---|
| ____ Footing | ____ Framing/60 minutes | ____ Wrap |
| ____ Foundation | ____ Framing/30 minutes | ____ Ice and Water |
| ____ Miscellaneous | ____ Insulation/Energy | ____ Retaining Wall (____ Footing ____ Backfill ____ Final) |
| ____ Poured Wall | ____ Fire Rated Assemblies | ____ Concrete Slab/Under Floor (example Radon) |
| ____ Final | ____ Lath | ____ Siding (____ Stone ____ Stucco ____ Brick) |

____ Sprinkled _____ Non-Sprinkled